



New 65m Explorer superyacht by Barracuda Yacht Design

Tuesday, 21 July 2015

By Charl van Rooy

The team at Barracuda Yacht Design has come up with a no-nonsense, go-anywhere explorer superyacht, with an iced-class design to allow this 65m world cruiser to reach places no other superyacht can.



With an 'indestructible' exterior image, and naval architecture to match, the Explorer offers clients a true purpose built expedition yacht, other than yachts that have been converted from military or research platforms. Her prominent bow with distinctive double-chine effect allows the Explorer to handle rough weather well, while keeping decks as dry as possible.

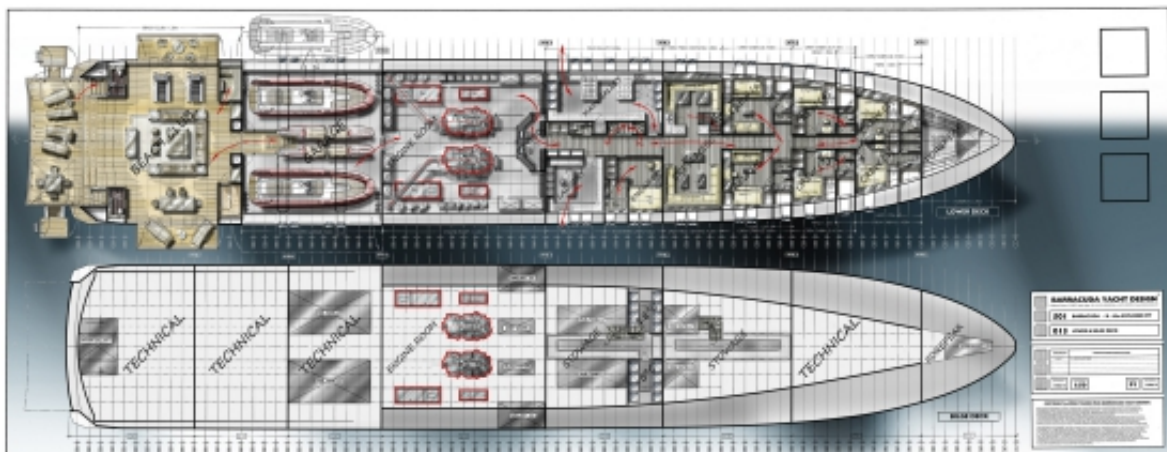

An exploration deck with multipurpose crane is located on main deck and provides good access for the launching of her two submarines, two Jeep style vehicles and two limousine style tenders which is housed in an enclosed garage, along with four jet skis. The interior on main deck provides accommodation in four guest cabins and a VIP suite, all accessed via a private hall. A large internal lounge is also available to guests situated aft of the accommodation area.

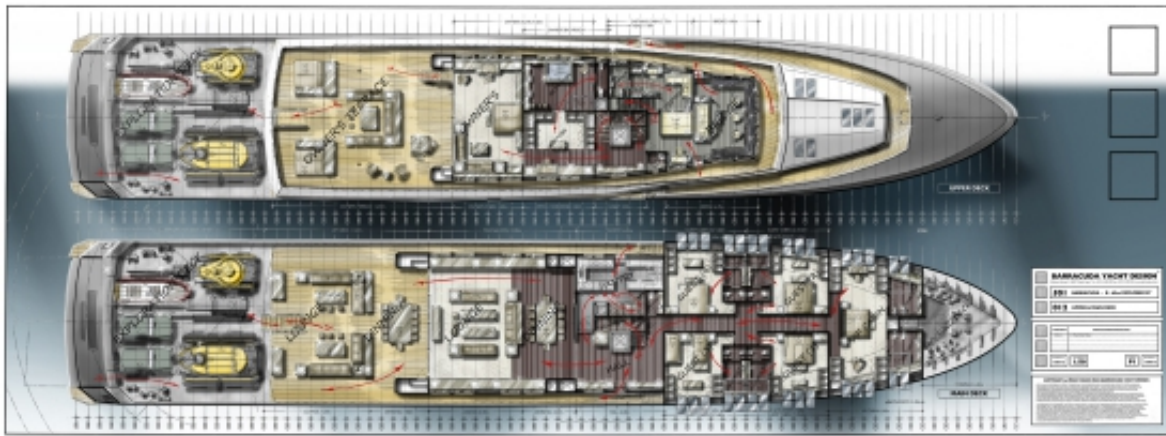

The upper deck above is set out for the use of the owner and offers a huge private aft-facing terrace. The master cabin and captain's cabin make up the remainder of the sleeping quarters.

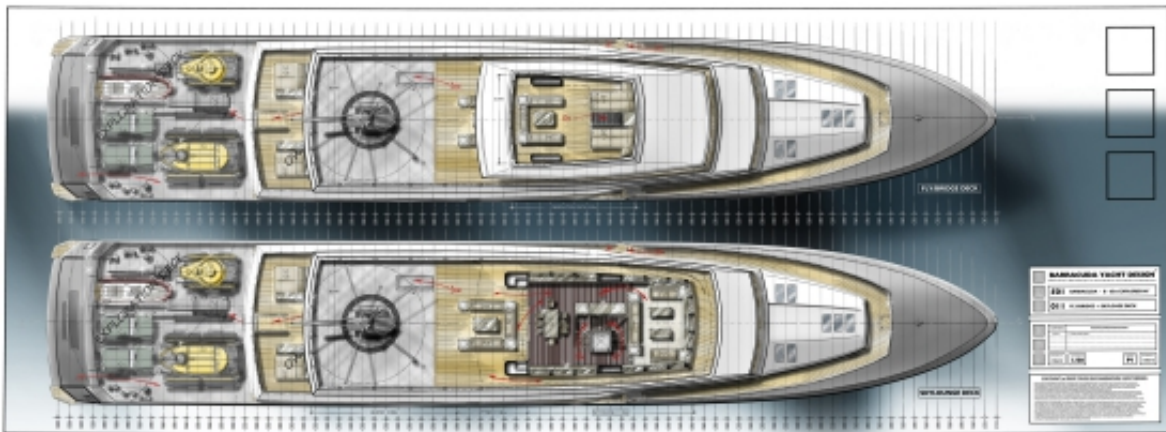

Guests are treated with wonderful panoramic views from the sky lounge, and will be able to experience the action from helicopter operations from here as well.

The yacht will have a top speed in the region of 16-18 knots, and offers a range of up to 7000nm.